

REPLACEMENT PARTS FOR BERKEL SLICING MACHINES

FOR USE WITH

 SLICING MACHINES

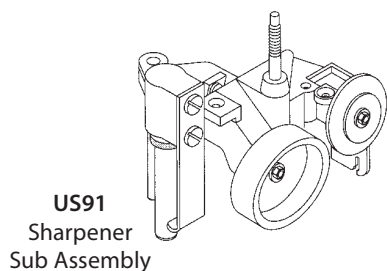

US91
Sharpener
Sub Assembly



US80
Sharpener
Cover Knob

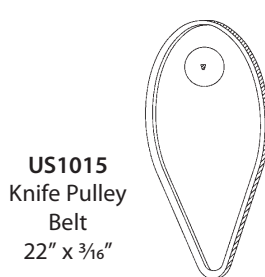

US1015
Knife Pulley
Belt
22" x 3/16"



US119
Knife Pulley
Belt
22" x 3/8"

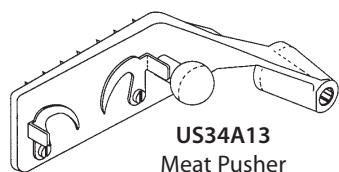

US34A13
Meat Pusher
Assembly (Chrome)



US0456
Knob



US81
Shaft Spring

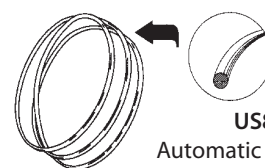

US82
Automatic Drive Belt
Round - 60"

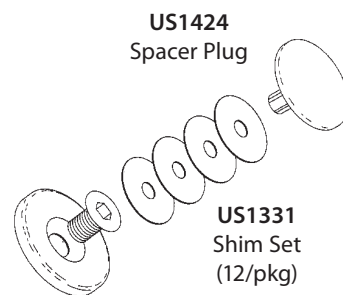

US1424
Spacer Plug



BSK1
Slicer Knife
Stainless Steel
12 1/2" Diameter



BST1
Sharpener Stones

US20A107
Knife Washer &
Screw Assembly - N/S

US1331
Shim Set
(12/pkg)

Item Number	Description
US91	Sharpener Sub Assembly
US80	Sharpener Cover Knob
US1015	Knife Pulley Belt
US119	Knife Pulley Belt
US34A13	Meat Pusher Assembly
US0456	Knob
US81	Shaft Spring
US82	Automatic Drive Belt - Round Polyurethane
BSK1	Slicer Knife, Stainless Steel
BST1	Sharpener Stones, Set
US1424	Spacer Plug
US20A107	Knife Washer & Screw Assembly - N/S
US1331	Shim Set (12/pkg)

FITS MODELS					
807	808	817	818	909	919
X	X	X	X	X	X
X	X	X	X	-	-
-	X	-	X	-	-
-	-	-	-	X	X
X	X	X	X	X	X
-	X	-	X	X	X
X	X	X	X	X	X
X	X	X	X	X	X
-	X	-	X	-	-
-	X	-	X	-	-
-	X	-	X	-	-

Accessories available when ordering: White poly top, backsplash, upper shelf, pot rack and heavy duty locking casters. Enclosed tables with sliding doors available. Custom tables for your specific needs built to order. Please call for details.

UTILITY WORKTABLES

STAINLESS STEEL TOP WITH STAINLESS STEEL LEGS AND UNDERSHELF

All stainless steel construction. Heliarc welded for strong, clean joints. Top is 16 gauge with rolled edges. Base is constructed of 1 1/2" round legs with adjustable internal feet. Standard 30" wide, 34" high, 4 or 6 legs as required. Choice of open base or with undershelf.

OPEN BASE

- SST4830..... 48" Long
- SST6030..... 60" Long
- SST7230..... 72" Long
- SST9630..... 96" Long
- SST12030 .. 120" Long



WITH UNDERSHELF

- SST4830S 48" Long
- SST6030S 60" Long
- SST7230S 72" Long
- SST9630S 96" Long
- SST12030S .. 120" Long



STAINLESS STEEL TOP WITH GALVANIZED LEGS AND UNDERSHELF

- Standard 30" wide, 35" high with adjustable bullet feet
- Shipped knocked down
- Easy to assemble

- ESS4830S ... 48" Long
- ESS6030S ... 60" Long
- ESS7230S ... 72" Long
- ESS9630S ... 96" Long

