

SOLID PLASTIC STOMPERS

| Item Number | Diameter | Overall Length | Length Below Collar |
|-------------|----------|----------------|---------------------|
| GR0811 | 2" | 17" | 11 3/4" |
| GR0715 | 3 1/2" | 19 7/8" | 15 5/8" |
| GR067 | 2" | 12 1/2" | 7 1/4" |
| GR05 | 2" | 11 3/4" | 6 1/2" |
| GR0413 | 2 3/4" | 17 1/2" | 13 1/2" |
| GR0314 | 2" | 19" | 14" |
| GR027 | 1 1/2" | 12" | 7" |
| GR016 | 2" | 10 1/2" | 6" |

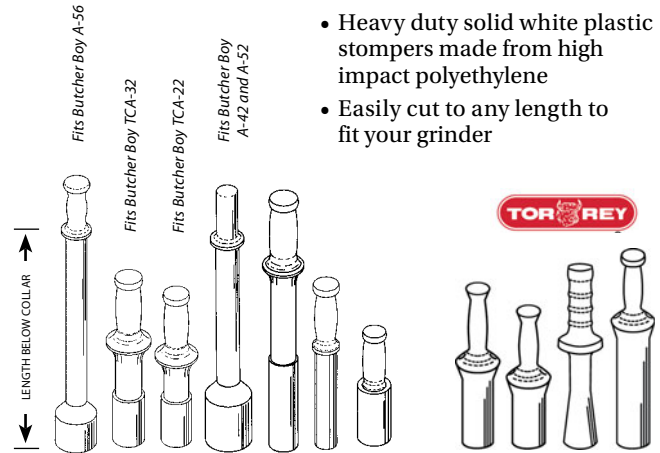

- Heavy duty solid white plastic stompers made from high impact polyethylene
- Easily cut to any length to fit your grinder

| Item Number | Diameter | Overall Length | Length Below Collar |
|-------------|----------|----------------|---------------------|
| M12FSS | 2" | 10 1/2" | 5 3/4" |
| M12/22S | 2 1/8" | 9 1/2" | 4 3/4" |
| M22R1S | 2 1/4" | 12 1/4" | 7" |
| M32S | 2 1/8" | 13 1/4" | 8 1/2" |

SPANNER/GRINDER RING WRENCHES

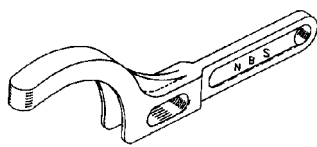

SW80
BUTCHER BOY

Fits models: A42, AU42, A52, AU52, 100/42, 100/52, 200/42, 200/52, 250/52.



HSW80
HOBART

Fits models: 4246, 4346, 4352, 4632, 4632A, 4732, 4732A.

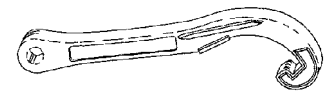

SW340
BIRO

Fits all 32 models.

GRINDER RINGS AND STUDS

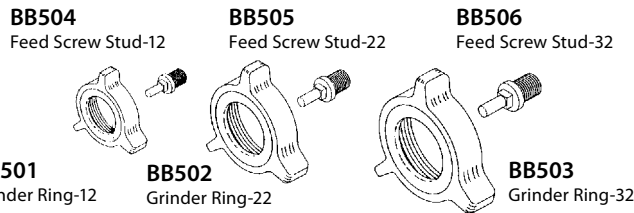

BUTCHER BOY

| Item Number | Description | Fits Models |
|-------------|-----------------|-------------|
| BB504 | Feed Screw Stud | TCA-12 |
| BB501 | Grinder Ring | TCA-12 |
| BB505 | Feed Screw Stud | TCA-22 |
| BB502 | Grinder Ring | TCA-22 |
| BB506 | Feed Screw Stud | TCA-32 |
| BB503 | Grinder Ring | TCA-32 |

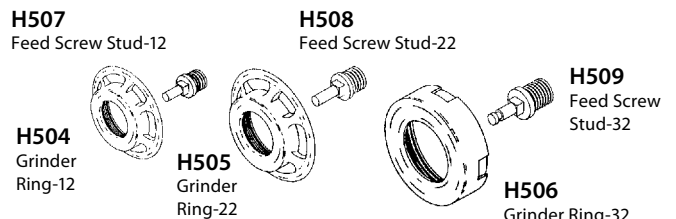

HOBART

| Item Number | Description | Fits Models |
|-------------|-----------------|-------------|
| H507 | Feed Screw Stud | 4612 & 4812 |
| H504 | Grinder Ring | 4612 & 4812 |
| H508 | Feed Screw Stud | 4822 |
| H505 | Grinder Ring | 4822 |
| H509 | Feed Screw Stud | 4632 & 4732 |
| H506 | Grinder Ring | 4632 & 4732 |

Many more grinder replacement parts available. Please call for your specific needs.

EXTRA BLADES

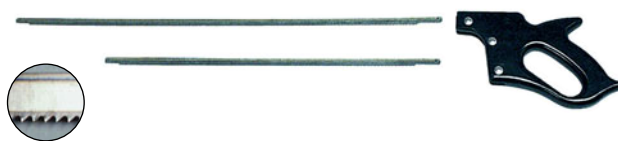

| | |
|--------|--|
| EX251 | 25" x 1/2" Blades - Individual |
| EX2512 | 25" x 1/2" Blades -12 Pack \$\$ |
| EX191 | 19" x 1/2" Blades - Individual |
| EXH | Replacement Handle Only Black Plastic (Bolts Included) |

HAND SAWS

- Sanitary black plastic handle and chrome steel frame
- One blade included with all saws



| | |
|------|-------------------------------------|
| CH25 | Market Size Hand Saw with 25" Blade |
| CH19 | Hand Saw with 19" Blade |

TOLL FREE: (800) 852-2806